

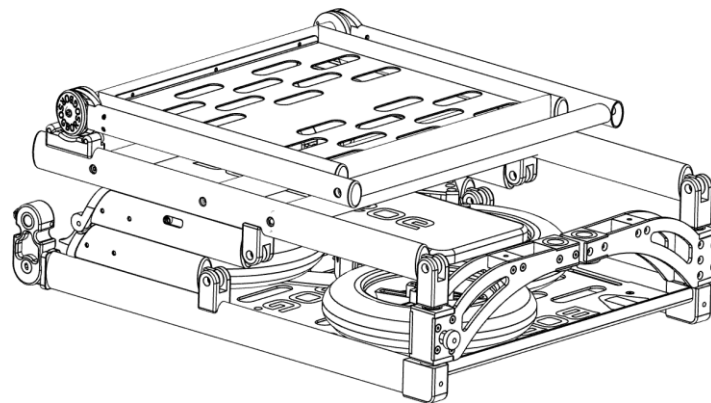

**MANUAL FOR FOLDING THE MULTI-PURPOSE CART  
FOR EQUESTRIAN EQUIPMENT - BORSOG ONE**

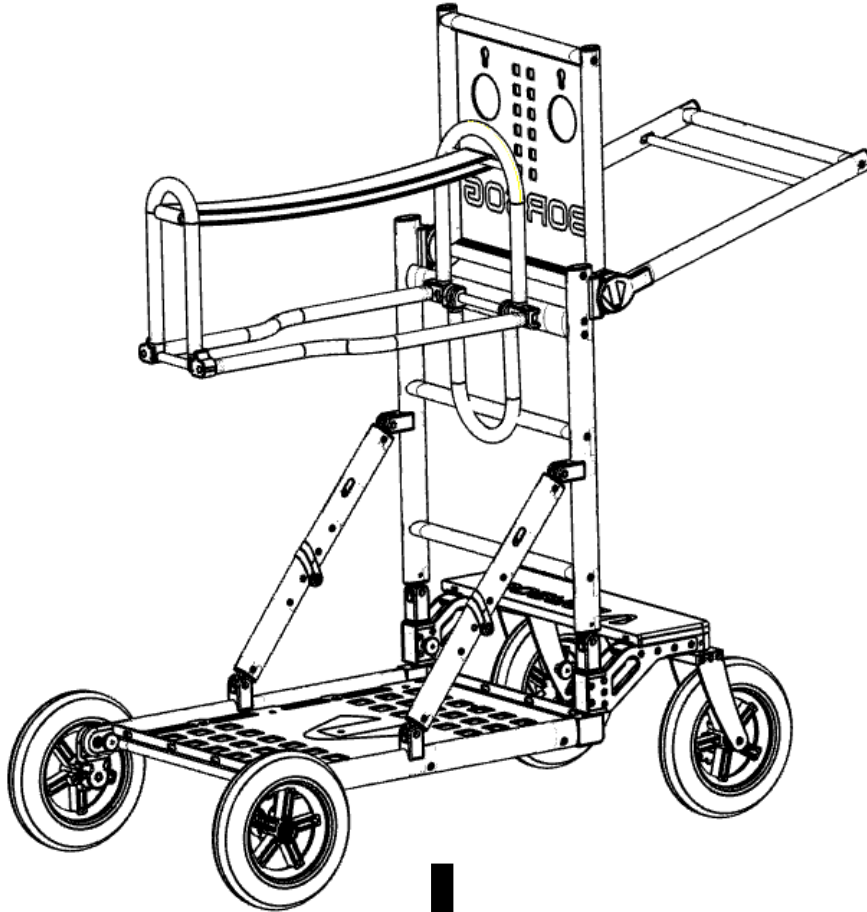

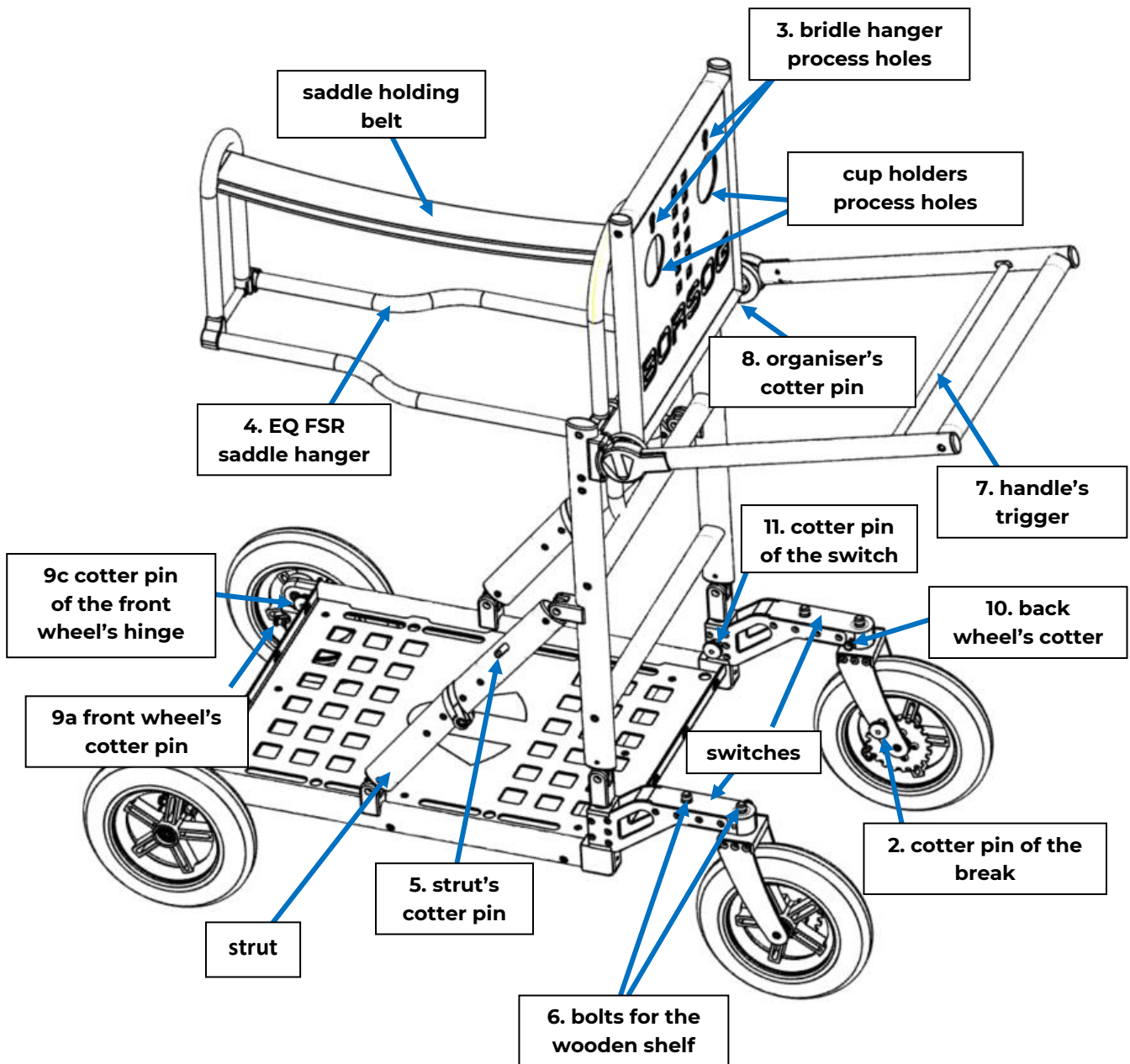

1. Place the transport belt along the movement direction and hover over it to find the belt under the midpoint of the floor and its ends protruding equally from both sides.
2. Lock the breaks by pulling and twisting the red cotter pins in the back wheels.
3. Remove your equipment and dismantle the additional BORSOG accessories (e.g. the EQ FSPR saddle pads rail, EQ ABH bridle hanger, etc.) by pulling them out from the process holes.

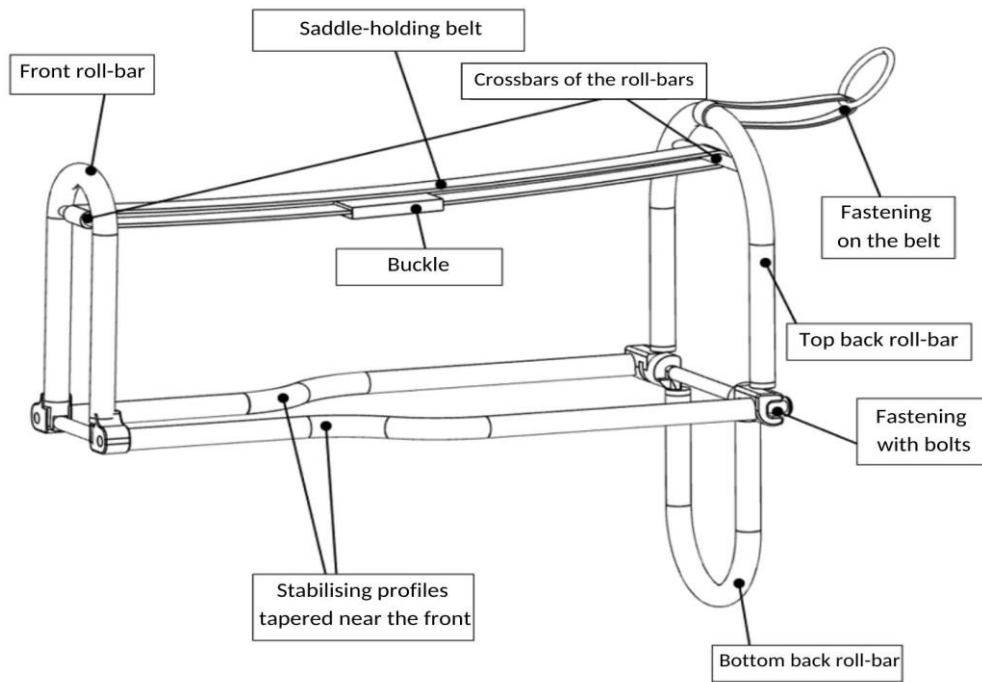

4. Dismantle and fold the EQ FSH saddle hanger by following these steps:
- Remove the belt and hang it temporarily on the organizer
  - Dismantle the hanger from the cart by moving it towards the process holes and pulling it out from the holes
  - Turn the hanger by 180° when holding the top back roll-bar as well as one of the stabilising profiles
  - Fold the roll-bars in. They should be placed on the same surface as the stabilising profiles.
  - Fasten the hanger with the belt.
  - Hang the hanger on the top crossbar at the back of the ladder by hooking it on the insets by the front roll-bar.

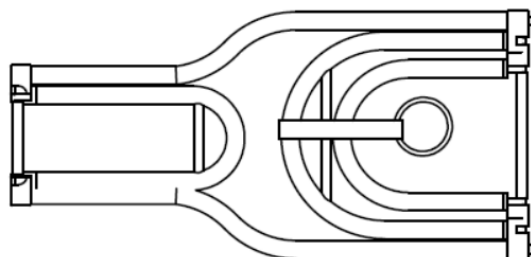
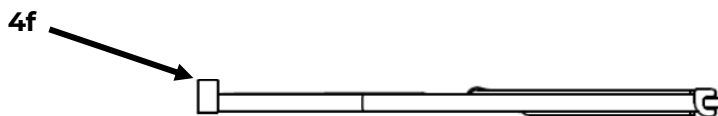



5. Release the struts by lifting their cotter pins and folding them in half.

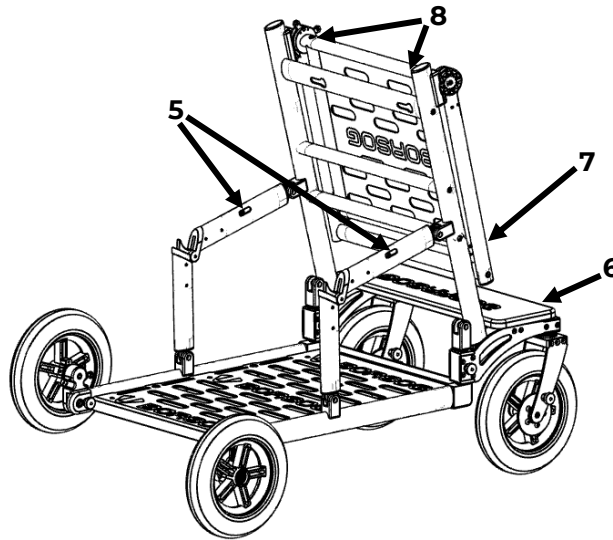

6. Remove the shelf by pulling it to the back and taking it off the bolts. Put the shelf inside the cart.
7. Push the handle's trigger and fold the handle.
8. Pull the organiser's cotter pins out and fold the organiser.
9. Remove the front wheels by pulling the cotter pins (9a) and pulling the wheels out from the hinges to one side (9b). Then pull the cotter pin of the front hinge out (9c) and twist it by 180° to the top (9d). Place the wheels in the bag inside the cart.

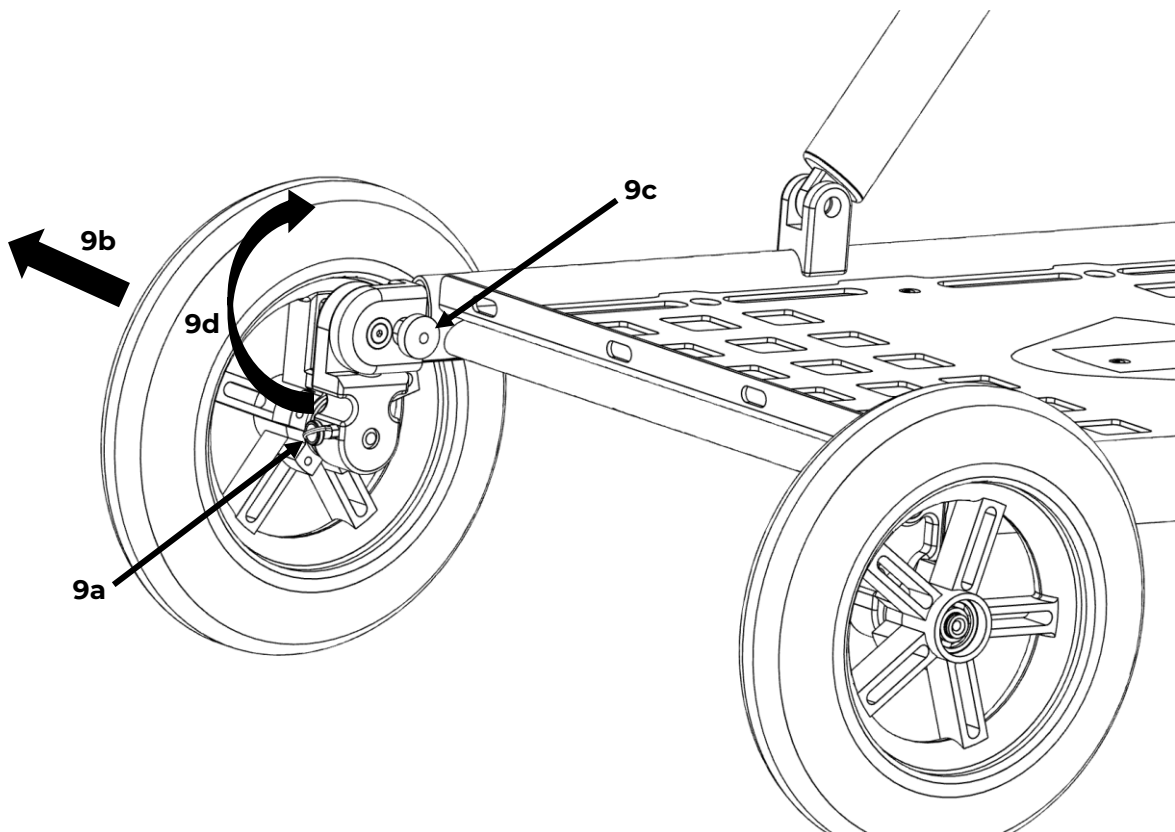



10. Remove the back wheels by pulling the cotter pins out (10a) and pulling them from the switches down (10b). Place the wheels in the bag.
11. Pull the cotter pins of the switches from the inside, then fold the switches so as its sides are in line with the cart's dais. The cotter pins should click and lock in this position.

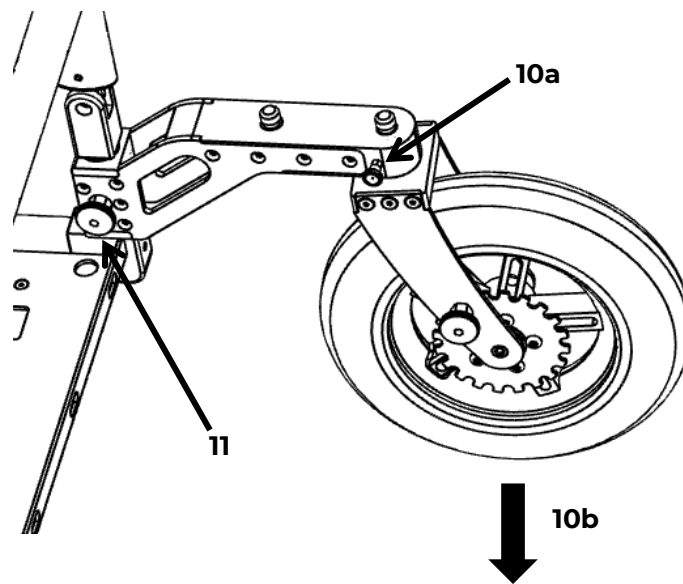

12. Fasten the transport belt.

